

Installation instructions for PZ4AL-01927-00, PZ4AL-01928-00 Under Run Protective Shield Fuel tank

LEXUS GX



TOYOTA LC



Model Year: **GX 460 - 2009 - 2013** **LC 150 Diesel - 2009** **LC 150 Petrol - 2009**

Vehicle Code: **URJ150L-GKTZKW** **KDJ15*L-G***YW** **GRJ150L-G***KW**

Part Number: Steel: PZ4AL-01927-00
Aluminium: PZ4AL-01928-00

 Weight:

Steel: 13,49 kg
Aluminium: 8,91 kg

 Installation Time:

40 min

PZ4AL-01927-00, PZ4AL-01928-00

A

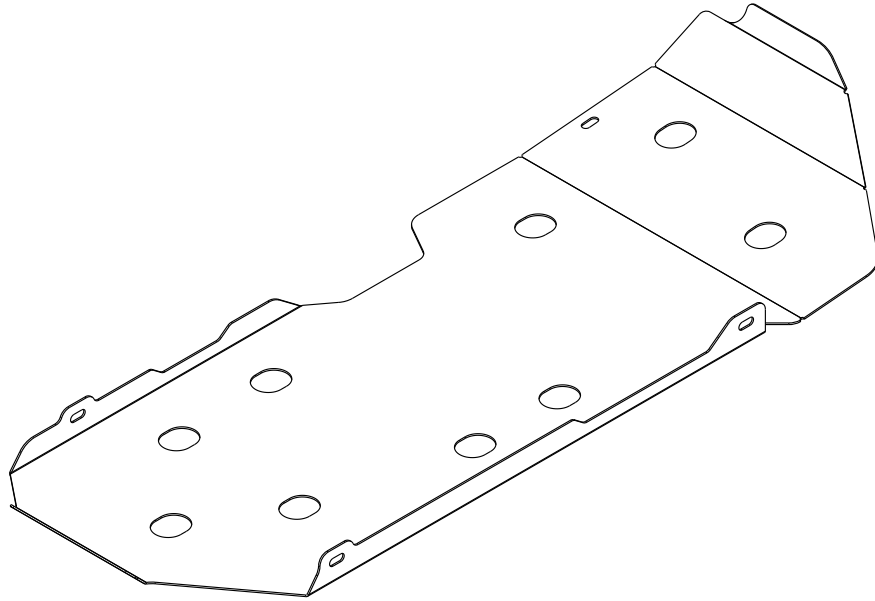

1x

PZ4AL-01927-60

B1

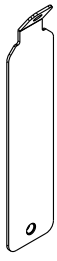

1x

B2

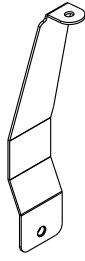

1x

B3

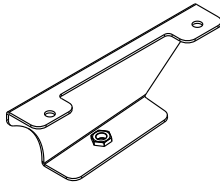

1x

B4



1x

C

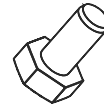

M10x20

4x

D

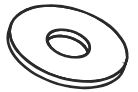

Ø 10

4x

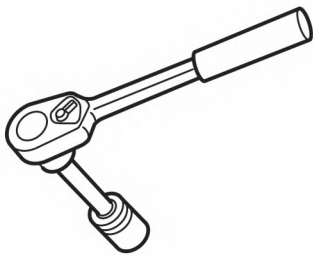

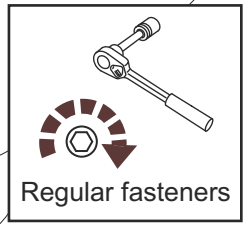
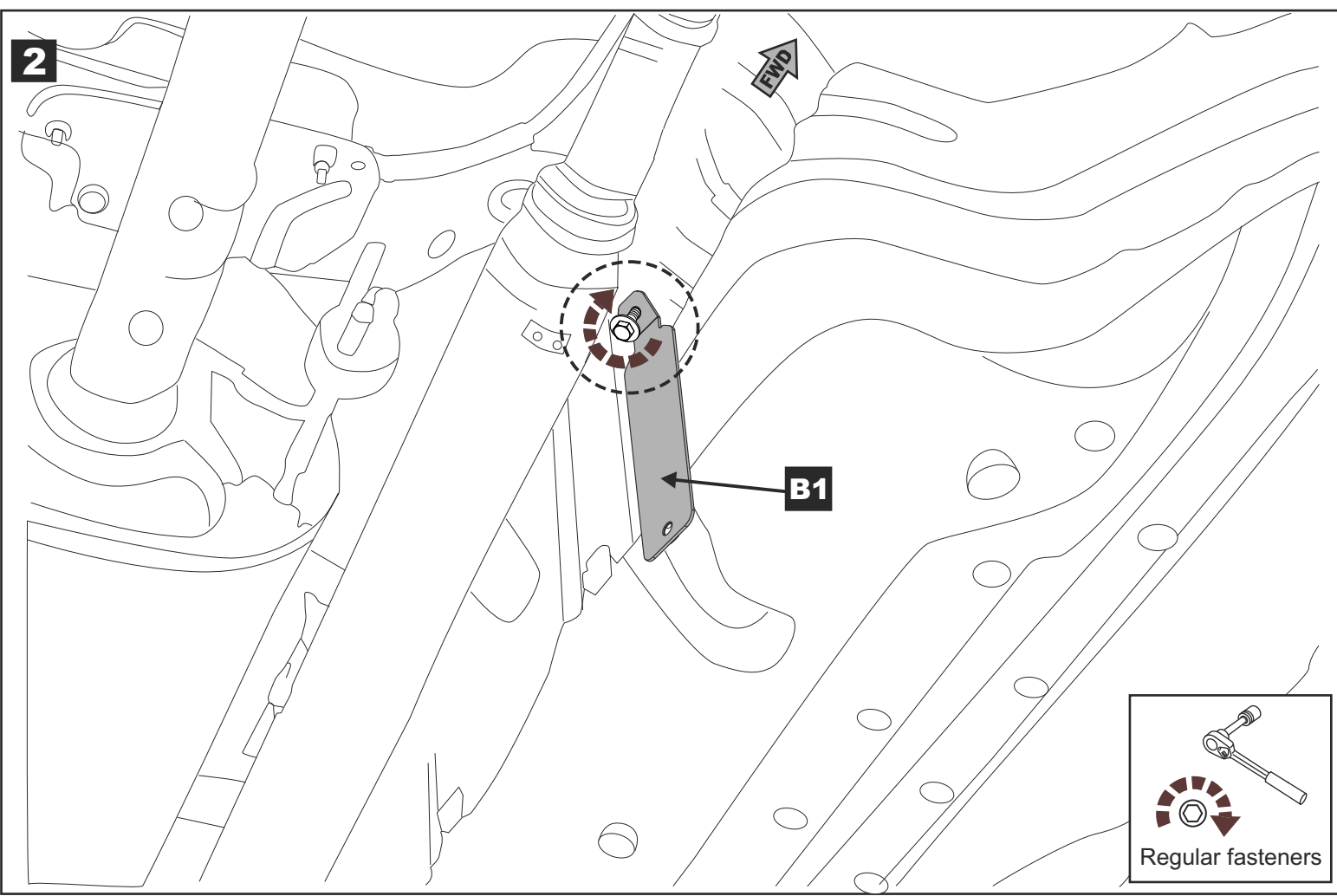
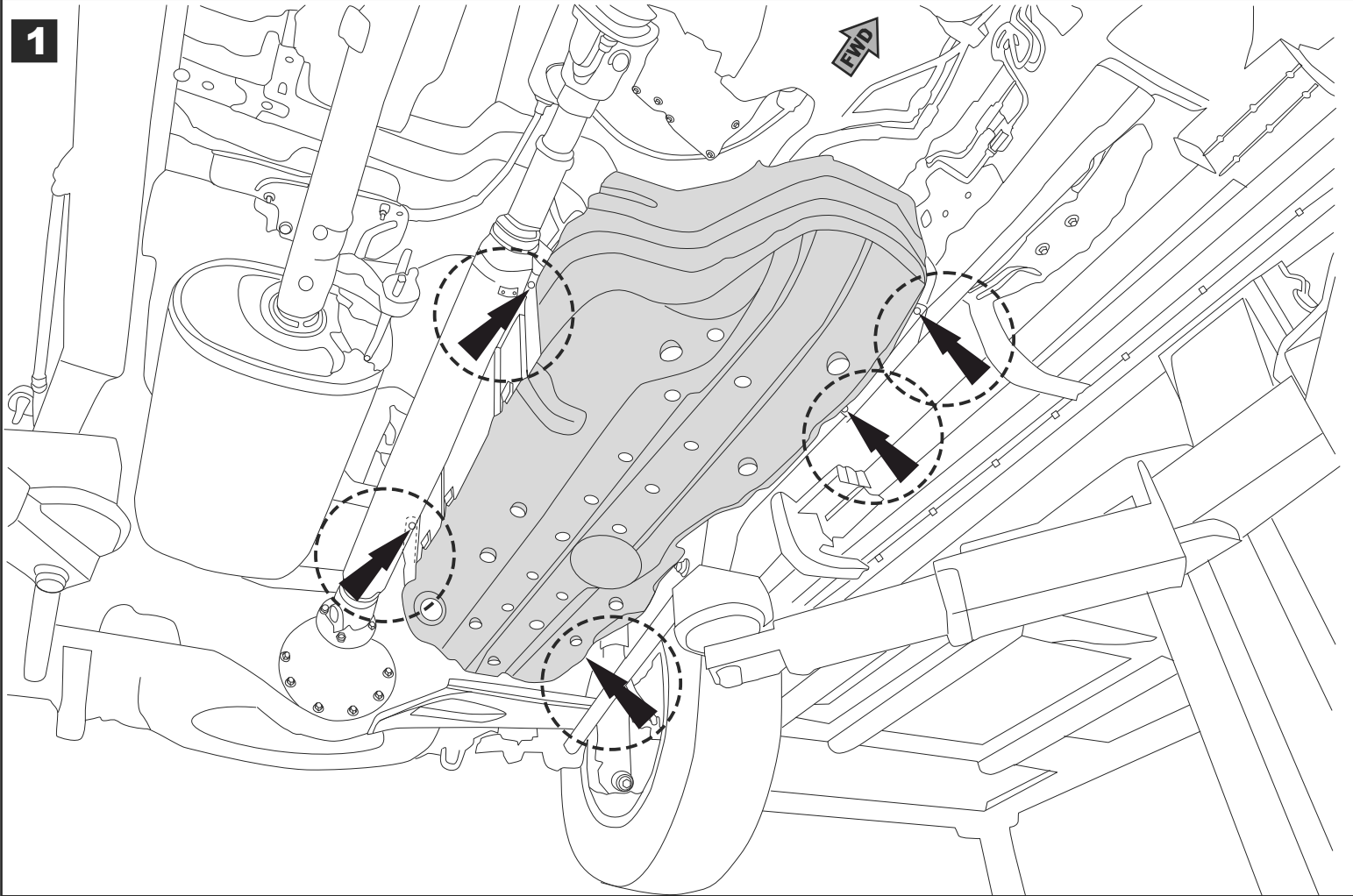

3

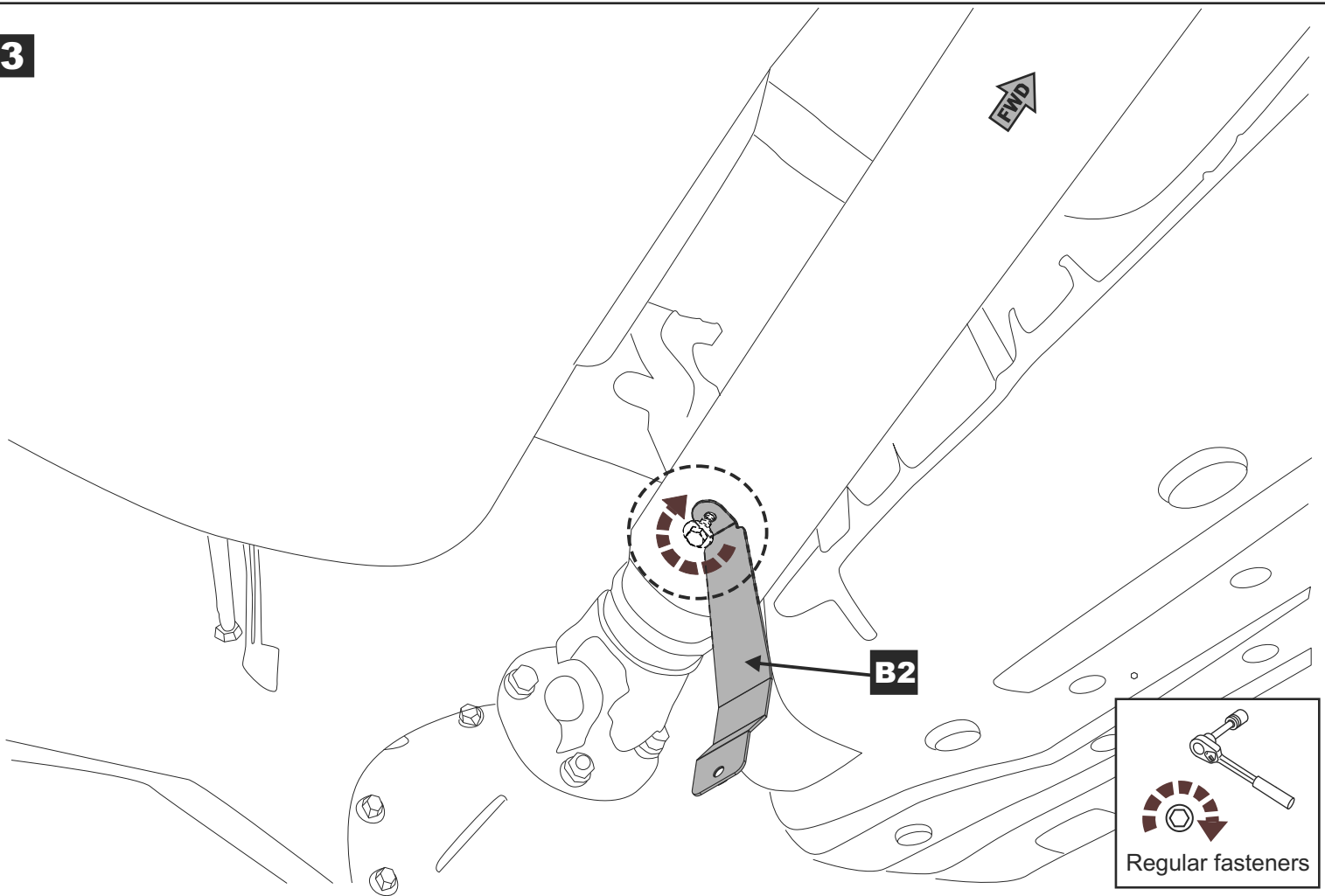

4

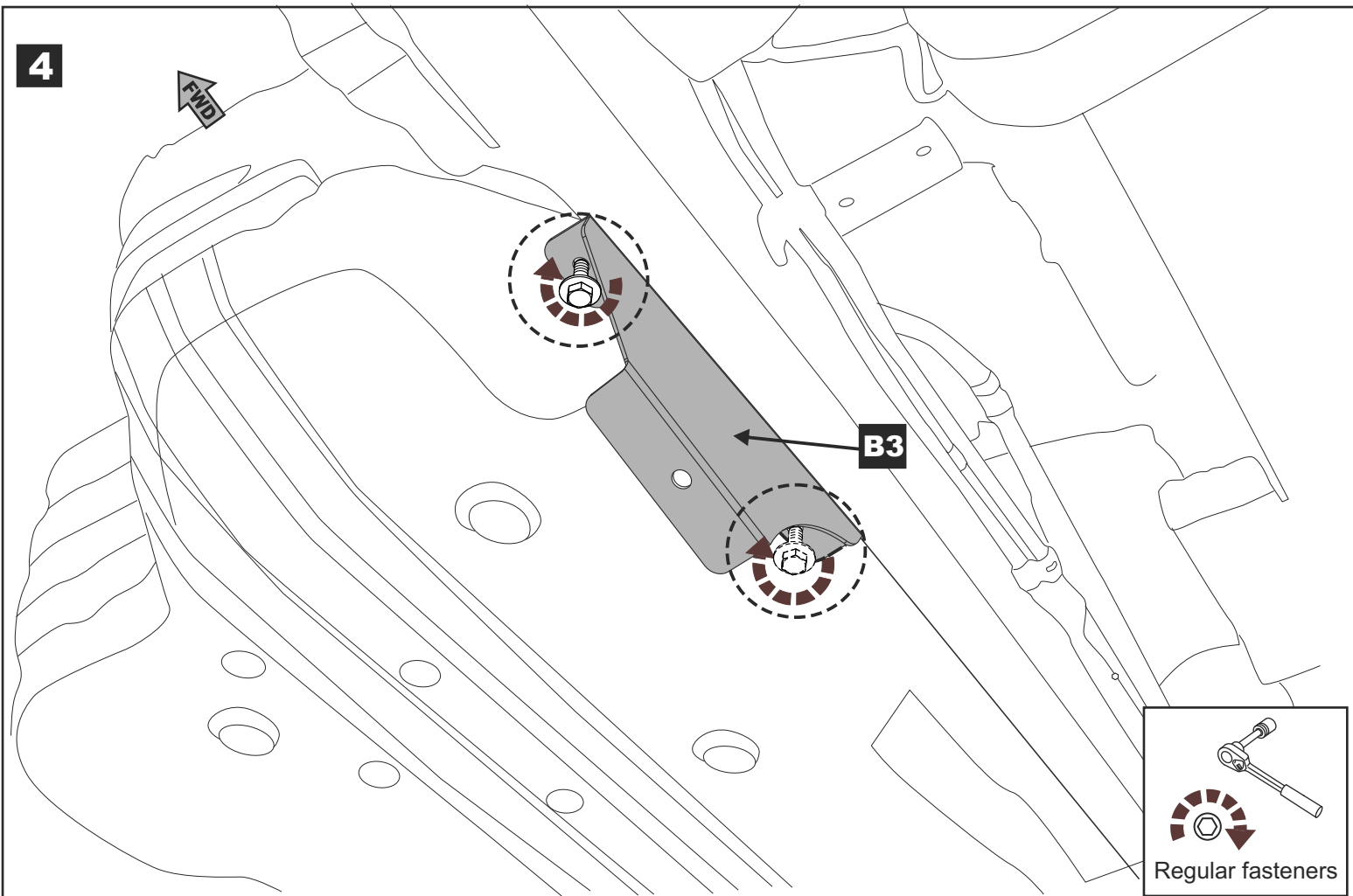

5

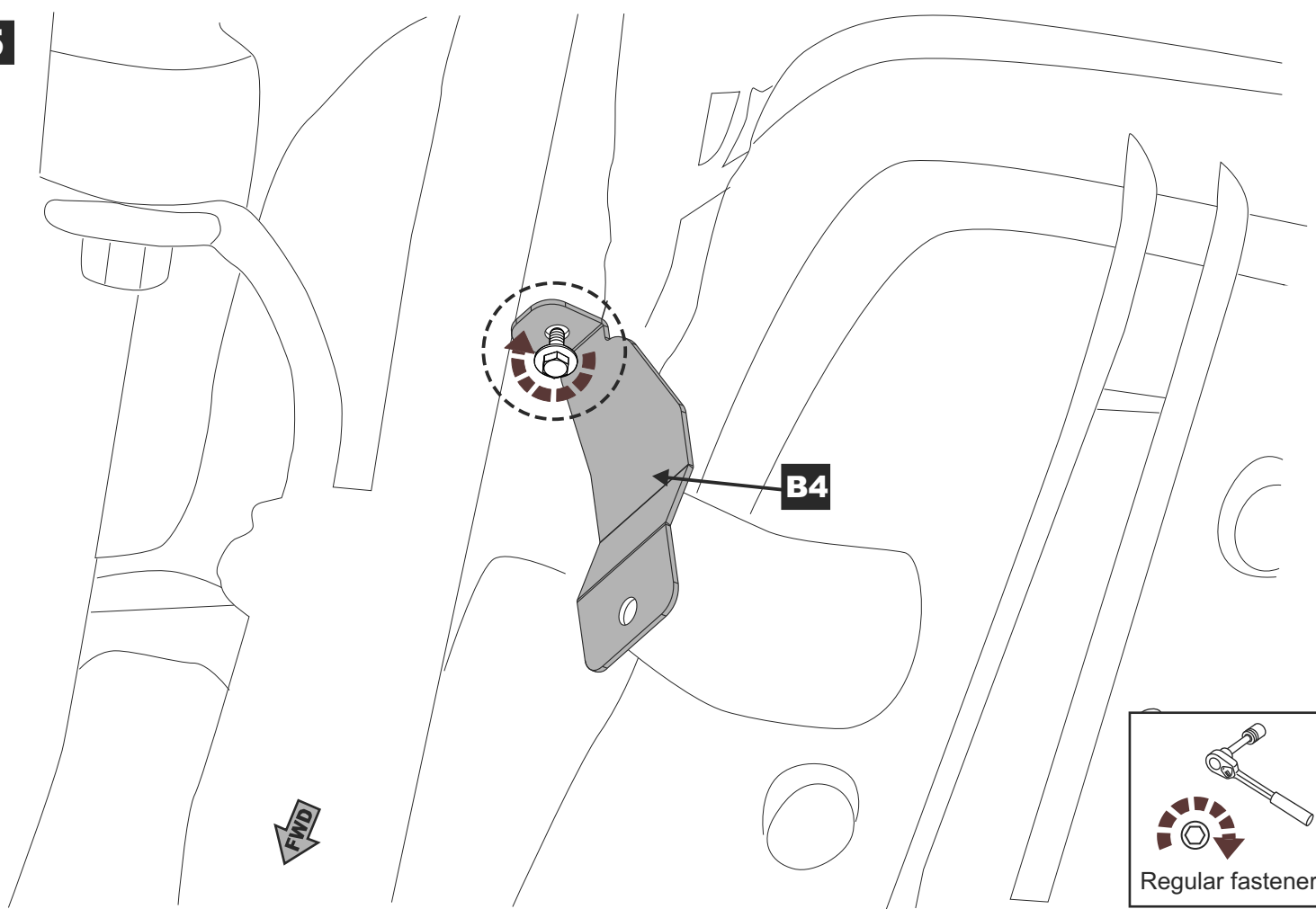

6

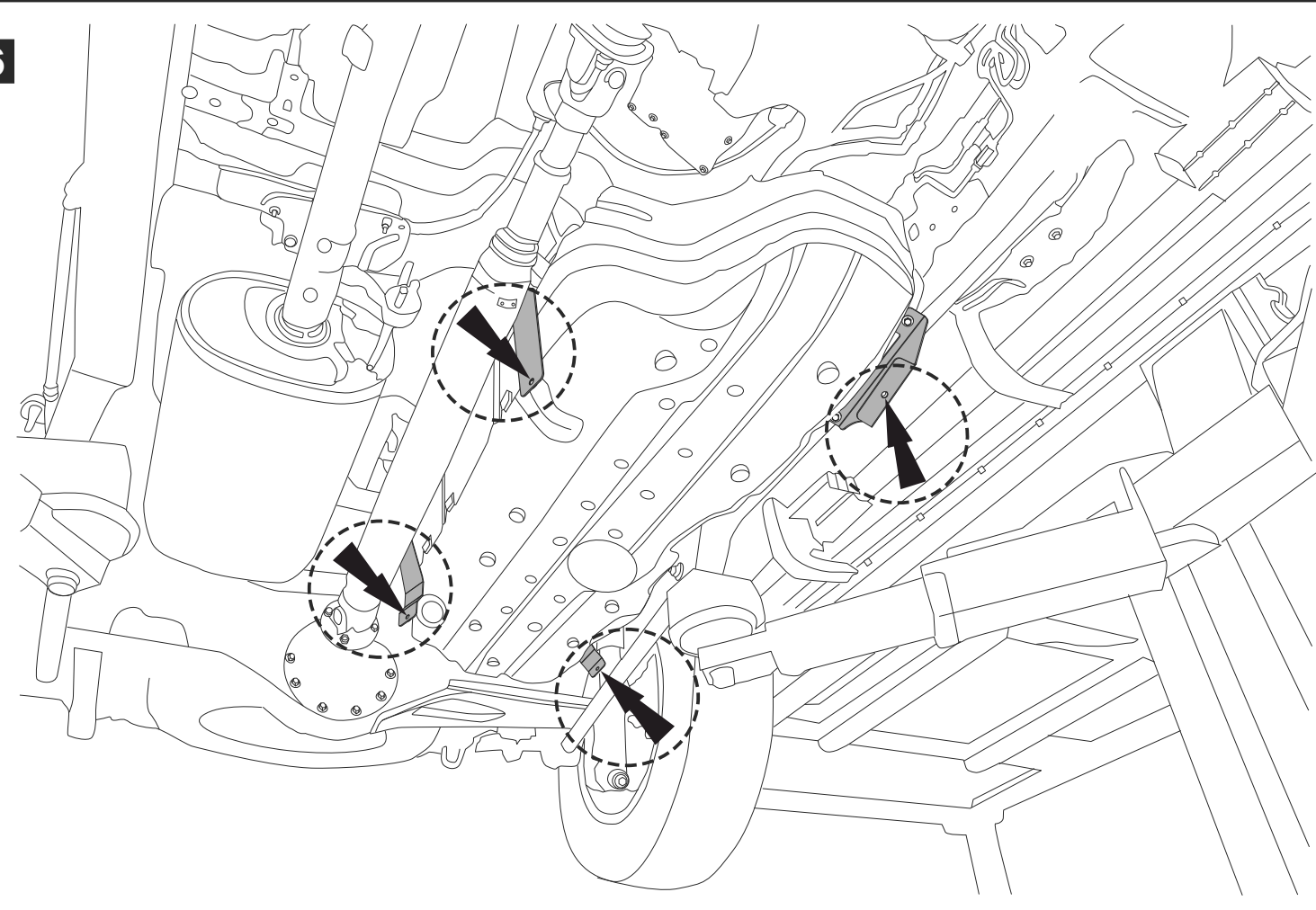

7

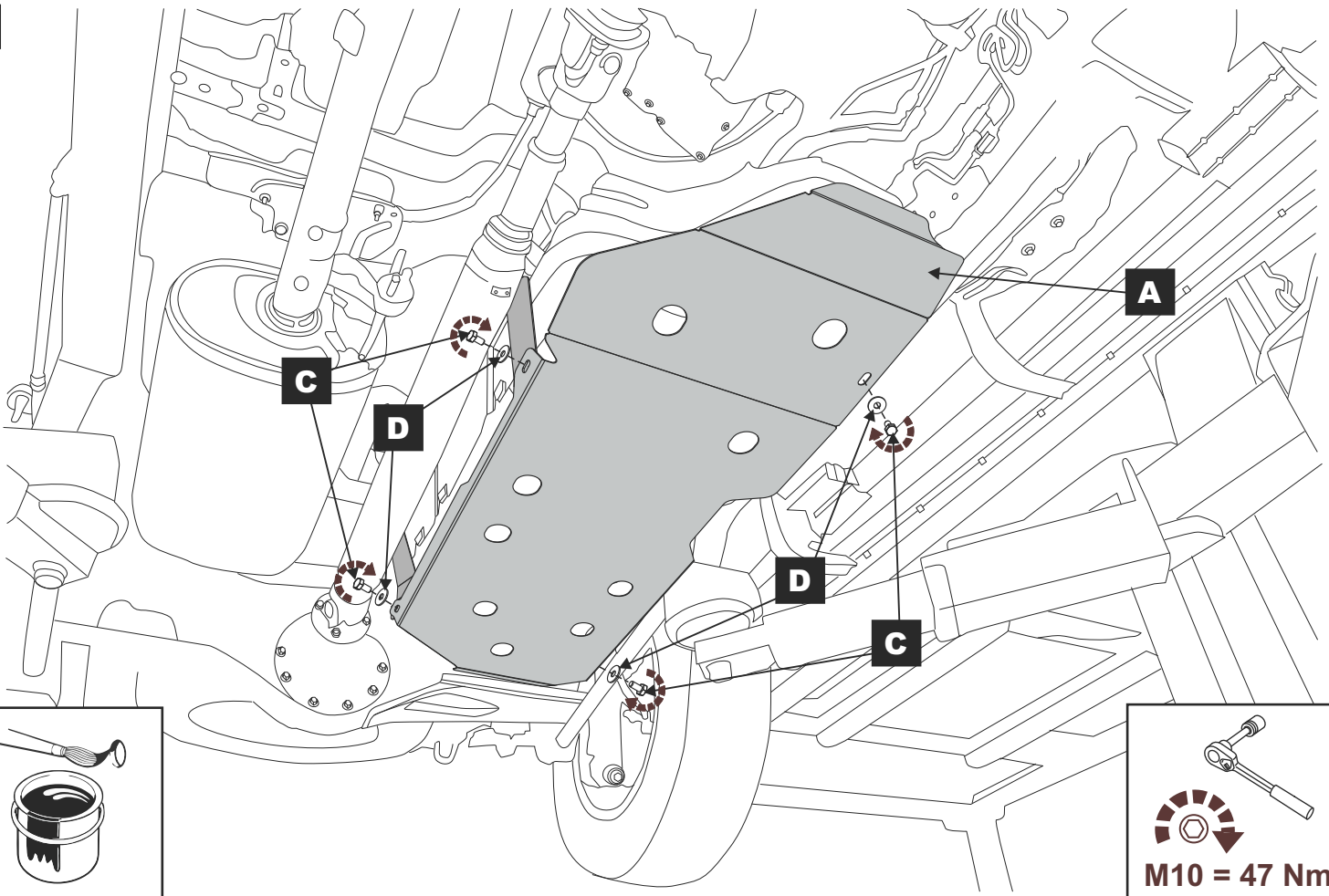

8

