

## TOW BAR PEUGEOT 407 (4D) (2004 - 2011) FITTING AND OPERATION MANUAL.

**Cat. No.P-040**

### DESTINATION

Tow bar **P-040** is designed for towing a trailer. This ball hook has a current certification of approval authorizing the product with **e20** certification sign.

### FITTING CONDITIONS

Tow bar **P-040** can be used and operated in a car with proper technical conditions of body elements. Those parts cannot be mechanically damaged. The ball hook has to be installed and operated in a car according to this instruction. All bolts and nuts in ball hook have to be screwed down with proper torque (Mo). Torque values are given below:

M8	-	25 (Nm)	M12	-	85 (Nm)
M10	-	50 (Nm)	M16	-	200 (Nm)

### OPERATION CONDITIONS

The tow bar **P-040** has a rating plate describing correct and safe loads of the hook:

Typ: <b>P-040</b> <b>A50-X</b> <b>e20</b> 0040-00 D = 9,1 kN S = 75 kg R = 1600 kg	Tow bar catalogue number. Tow bar class (compressing device) Tow bar certification of approval number Theoretical related force working on a ball hook Max permissible vertical load of the hook ball Max permissible load of towing trailer
---	---

**D - force is calculated using the following formula:**

$$D = g \times \frac{T \times R}{T + R} \text{ kN}$$

**T**-technically permissible maximum mass in tonnes of the towing vehicle (also towing tractors) including, if necessary, the vertical load of a centrale axle trailer.  
**R**-technically permissible maximum mass in tonnes of the full trailer with drawgal free to move in the vertical plane or of the semi-trailer.  
**g**-acceleration due to gravity (assumed as 9,81 m/s<sup>2</sup>)

During operating individual elements of ball hook should be kept in a proper technical condition and protected from corrosion. The trailer must be linked with an elastic joint with proper durability (cord, chain) while towing. It is necessary to check periodically bolt joints during operating the ball hook. If screws are eased, it is necessary to screw them down.

### FITTING

The tow bar **P-040** is made up of the following elements:

1. Towbar mainframe	- 1 piece	9. Bolt M12x35	- 4 pieces
2. Tow ball	- 1 piece	10. Bolt M12x65	- 2 pieces
3. Right strengthening	- 1 piece	11. Spring washer 8,2	- 8 pieces
4. Left strengthening	- 1 piece	12. Spring washer 10,2	- 2 pieces
5. Electrical plate	- 1 piece	13. Spring washer 12,2	- 6 pieces
6. Special washer 30/ 10,5x3	- 2 pieces	14. Flat washer 8,4	- 8 pieces
7. Bolt M8x40	- 8 pieces	15. Flat washer 13,0	- 6 pieces
8. Bolt M10x35	- 2 pieces	16. Nut M12	- 6 pieces

Follow the general directions in order to fit **P-040** tow bar properly

1. Rear bumper **cutting is required**.
2. Remove the rear bumper of the car (remove the plastic element from the right side of bumper).
3. Remove the bumper strengthening.
4. Put towbar mainframe (1) to the back panel, next put the bumper strengthening and attach to the back panel using bolts M8x40 (7) together with spring washers 8,2 (11) and round washers 8,4 (14).
5. Attach right and left strengthenings (3, 4) to the chassis side members using bolts M10x35 (8) together with spring washers 10,2 (12) and special washers 30/ 10,5x3 (6) and attach to the towbar mainframe (1) using bolts M12x35 (9) together with round washers 13,0 (15), spring washers 12,2 (13) and nuts M12 (16).
6. Refit the rear bumper to the car.
7. Tighten the tow ball (2) and electrical socket (5) to the towbar mainframe (1) using bolts M12x65 (10) with round washers Ø13,0 (15), spring washers Ø12,2 (13) and nuts M12 (16).

**Obeying this instruction assures correct montage and the P-040 tow bar operating.**

After assembling of the tow bar **P-040** you have to get entry in cars **registration book**.

### CAUTION:

Check if all bolts and nuts are correctly tightened after 1000km. Keep tow ball clean, grease and cased. All mechanical damages of tow bar excludes its further exploitation. Damaged ball hook **cannot be repaired**. In case of braking the rules of montage or unproper usage manufacturer **do not take responsibility** for arised damages.

### MONTAGE DIAGRAM:

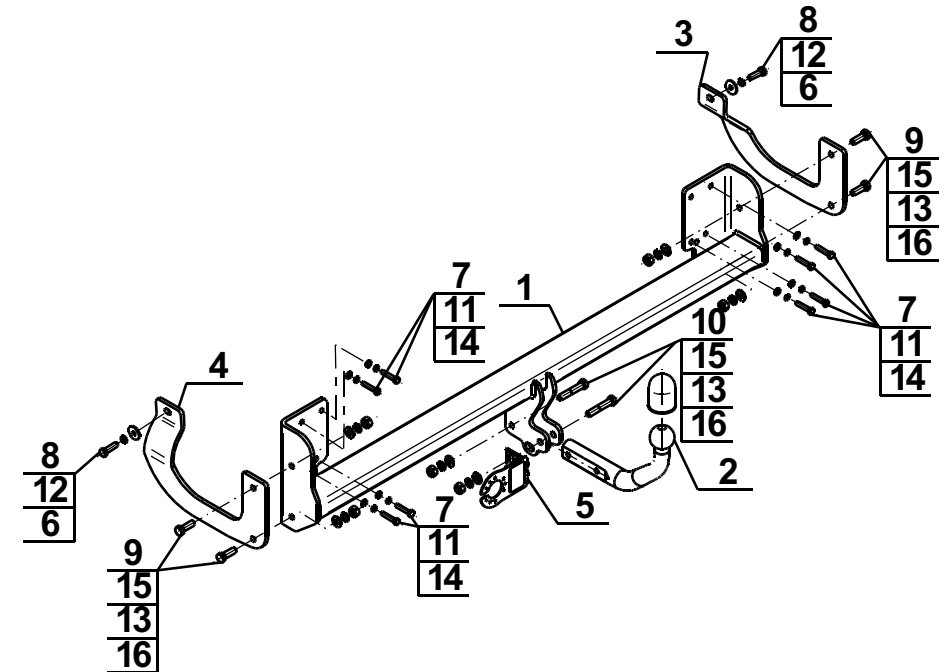

### NOTE:

Bunch of wires is not included (in total price).