

# TOW BAR H-236 FOR HYUNDAI GETZ FITTING AND OPERATION MANUAL.

( 2002 - r. )

Nr kat. H-236

## DESTINATION

Tow bar **H-236** for a **Hyundai Getz** is designed for towing a trailer. This ball hook has a current certification of approval authorizing the product with **E20** certification sign.

## FITTING CONDITIONS

Tow bar **H-236** can be used and operated in a car with proper technical conditions of body elements. Those parts cannot be mechanically damaged. The ball hook has to be installed and operated in a car according to this instruction. All bolts and nuts in ball hook have to be screwed down with proper torque (Mo). Torque values are given below:

M8	-	25 (Nm)	M12	-	85 (Nm)
M10	-	50 (Nm)	M16	-	200 (Nm)

## OPERATION CONDITIONS

The tow bar **H-236** has a rating plate describing correct and safe loads of the hook:

Typ: <b>H-236</b>	The tow bar for <b>Hyundai Getz</b>
<b>A50-X</b>	Tow bar class ( compressing device )
<b>E20 55R-01 1521</b>	Tow bar certification of approval number
<b>D = 6,5 kN</b>	Teoretical related force working on a ball hook
<b>S = 44 kg</b>	Max permissible vertical load of the hook ball
<b>R = 1100 kg</b>	Max permissible load of towing trailer

During operating individual elements of ball hook should be kept in a proper technical condition and protected from corrosion. The trailer must be linked with an elastic joint with proper durability ( cord , chain ) while towing .It is necessary to check periodically bolt joints during operating the ball hook. If screws are eased , it is necessary to screw them down .

## FITTING

The tow bar **H-236** for **Hyundai Getz** is made up of the following elements :

1. Tow bar's body	- 1 piece	5. Bolt M12x(1,25)x40	- 4 pieces
2. Tow ball with washers	- 1 piece	6. Bolt M12x95	- 2 pieces
3. Electrical socket holder	- 1 piece	7. Spring washer 12,2	- 6 pieces
4. Special washer 30/ 12,5x10	- 2 pieces	8. Flat washer 13,0	- 6 pieces
		9. Nut M12	- 2 pieces

In order to mount the ball hook **H-236** you have to obey the instruction below:

- 1.Rear bumper cutting is required.
- 2.Dismantle a tow bar into kit-form elements.
- 3.Dismantle rear bumper (together with strenghtening).
- 4.Remove protruding chip of fog lights placed on the back strip.
- 5.Put (1) to longitudinal stringers: the right support of (1) to the inside of longitudinal stringer and the left support from the outside of longitudinal stringer.
- 6.Put (4) between the right support of (1) and longitudinal stringer.
- 7.Screw (1) with longitudinal stringers using factory-made welded nuts M12x(1,25) and (5), (8), (7).
- 8.Pull the strenghtening from the rear bumper out.
- 9.Incise the strenghtenings from the right and right sides.
- 10.Mark and make an undercut of bumper (look at the drawing below).
- 11.Put the strenghtening to the bumper again, then screw the lot to a car.

27.04.2005.

Nr kat. H-236

- 12.Place (2) into (1) using (6), (8), (7), screwing (3) on the left side of (2) at the same time.
- 13.Check if all fixing bolts and nuts are screwed hard enough.

**Obeying this instruction assures correct montage and the tow bar operating in a Hyundai Getz.**

After assembling of the tow bar **H-236** you have to get entry in cars **registration book** in a quality control station .

## CAUTION :

All mechanical damages of tow bar excludes its further exploitation . Damaged ball hook **cannot be repaired**. In case of braking the rules of montage or unproper usage manufacturer **do not take responsibility** for arised damages .

## MONTAGE DIAGRAM :

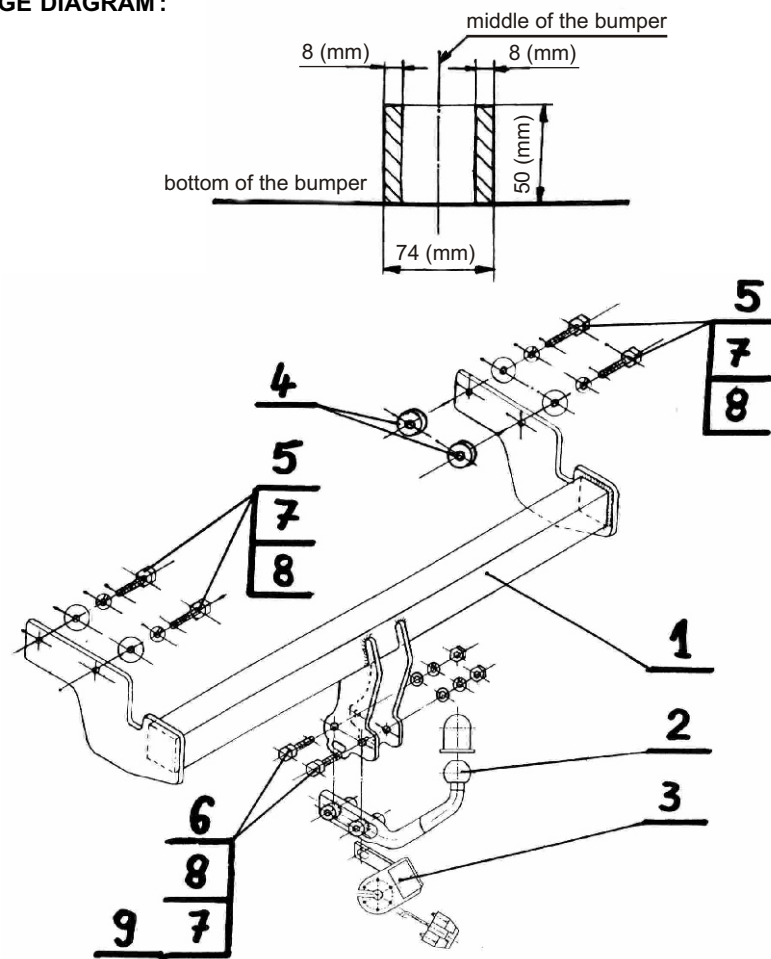

## NOTE :

Bunch of wires is not included (in total price).

Nr kat. H-236