

# TOW BAR C-032 CITROEN C5 (4/5D) (03/2001 - 09/2004 r.) FITTING AND OPERATION MANUAL.

Cat. No.C-032

## DESTINATION

Tow bar **C-032** for a **CITROEN C5 (4/5D)** is designed for towing a trailer. This ball hook has a current certification of approval authorizing the product with **e20** certification sign.

## FITTING CONDITIONS

Tow bar **C-032** can be used and operated in a car with proper technical conditions of body elements. Those parts cannot be mechanically damaged . The ball hook has to be installed and operated in a car according to this instruction . All bolts and nuts in ball hook have to be screwed down with proper torque (Mo) . Torque values are given below :

M8	-	25 (Nm)	M12	-	85 (Nm)
M10	-	50 (Nm)	M16	-	200 (Nm)

## OPERATION CONDITIONS

The tow bar **C-032** has a rating plate describing correct and safe loads of the hook :

Typ: <b>C-032</b>	The tow bar for <b>CITROEN C5 (4/5D)</b>
<b>A50-X</b>	Tow bar class ( compressing device )
<b>e20</b>	Tow bar certification of approval number
<b>0287-00</b>	Teoretical related force working on a ball hook
<b>D = 9,3 kN</b>	Max permissible vertical load of the hook ball
<b>S = 75 kg</b>	Max permissible load of towing trailer
<b>R = 1800 kg</b>	

**D - force is calculated using the following formula:**

$$D = g \times \frac{T \times R}{T + R} \text{ kN}$$

**T**-technically permissible maximum mass in tonnes of the towing vehicle (also towing tractors) including, if necessary, the vertical load of a centrale axle trailer.  
**R**-technically permissible maximum mass in tonnes of the full trailer with drawgal free to move in the vertical plane or of the semi-trailer.  
**g**-acceleration due to gravity(assumed as 9,81 m/s<sup>2</sup>)

During operating individual elements of ball hook should be kept in a proper technical condition and protected from corrosion . The trailer must be linked with an elastic joint with proper durability ( cord , chain ) while towing .It is necessary to check periodically bolt joints during operating the ball hook. If screws are eased , it is necessary to screw them down .

## FITTING

The tow bar **C-032** for **CITROEN C5 (4/5D)** is made up of the following elements :

1.Towbar mainfame	- 1 piece	6. Spring washer 10,2	- 4 pieces
2.Electrical socket plate	- 1 piece	7. Spring washer 12,2	- 2 pieces
3.Tow ball	- 1 piece	8. Flat washer 10,5	- 4 pieces
4.Bolt M10x40	- 4 pieces	9. Flat washer 13,0	- 2 pieces
5.Bolt M12x65	- 2 pieces	10.Nut M12	- 2 pieces

Follow the general directions in order to fit **C-032** tow bar properly:

- 1.Rear bumper cutting **is not required**.
- 2.Remove rear bumper.
- 3.Remove plactic made cover (will not be mount again).
- 4.Screw (1) from the bottom to chassis rails using (4) along with (6) and (8)

18.09.2007.

Cat. No. C-032

- 5.Mount rear bumper
6. Attach (3) to (1) along with (2) using (5) and (9), (7), (10).
- 7.Check if all bolts and nuts are correctly tightened.

**Obeying this instruction assures correct montage and the tow bar operating in a CITROEN C5 (4/5D).**

After assembling of the tow bar **C-032** you have to get entry in cars **registration book** in a quality control station .

## CAUTION :

All mechanical damages of tow bar excludes its further exploitation . Damaged ball hook **cannot be repaired**. In case of braking the rules of montage or unproper usage manufacturer **do not take responsibility** for arised damages .

## MONTAGE DIAGRAM:

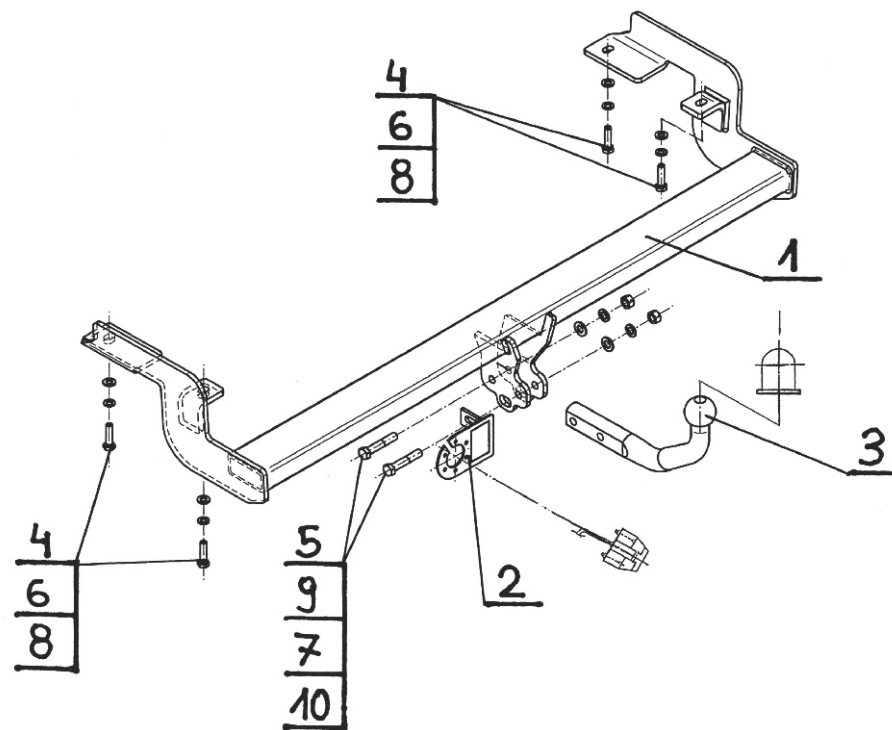

## NOTE :

Bunch of wires is not included (in total price).

Cat. No. C-032